

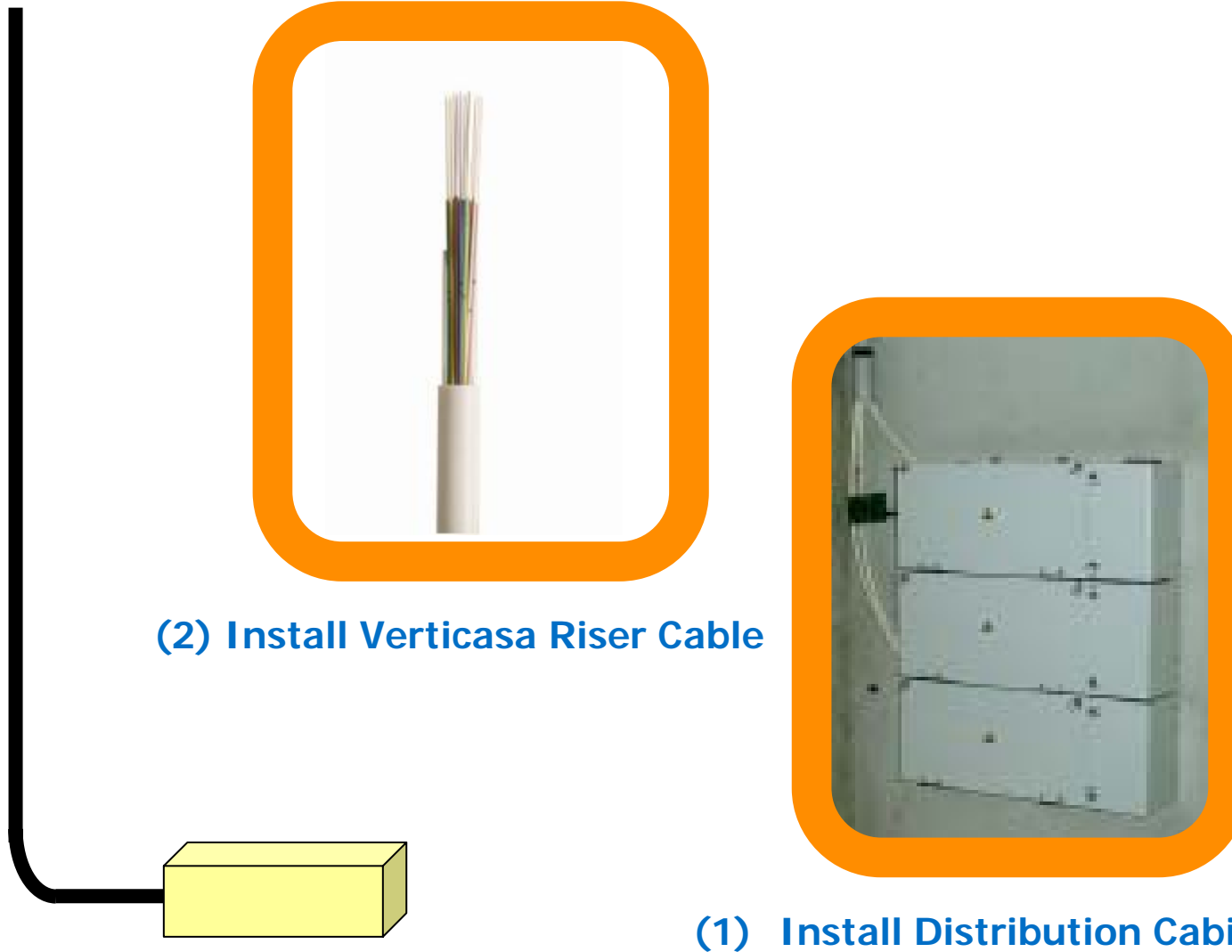



- **Prysmian presents its new innovative solution for cost effectively delivering FTTH to subscribers located in multi-dwelling units (MDU's).**
- **The VERTICASA™ system combines the latest optical fibre technology with new optical cable and connectivity products.**



VertiCasa Installation

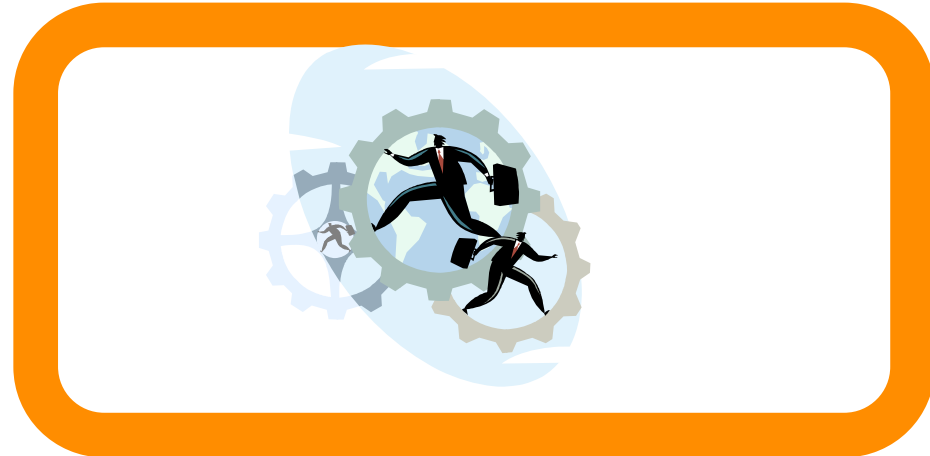
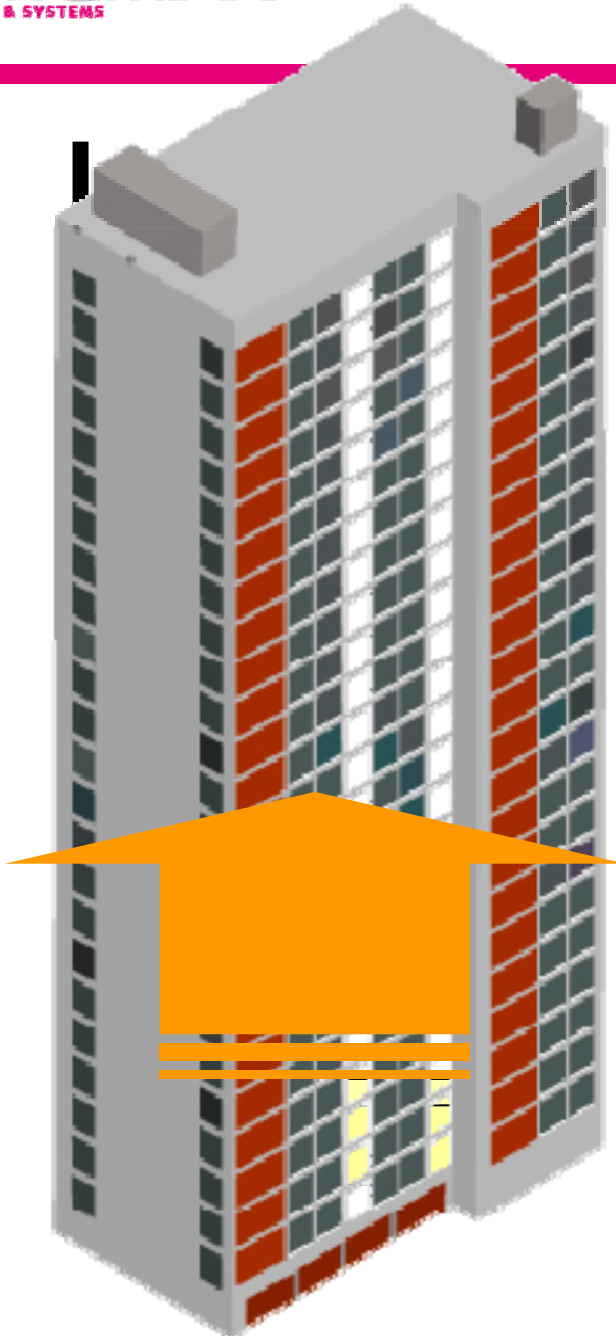

(4) Walk to the 4th or 5th Floor of building

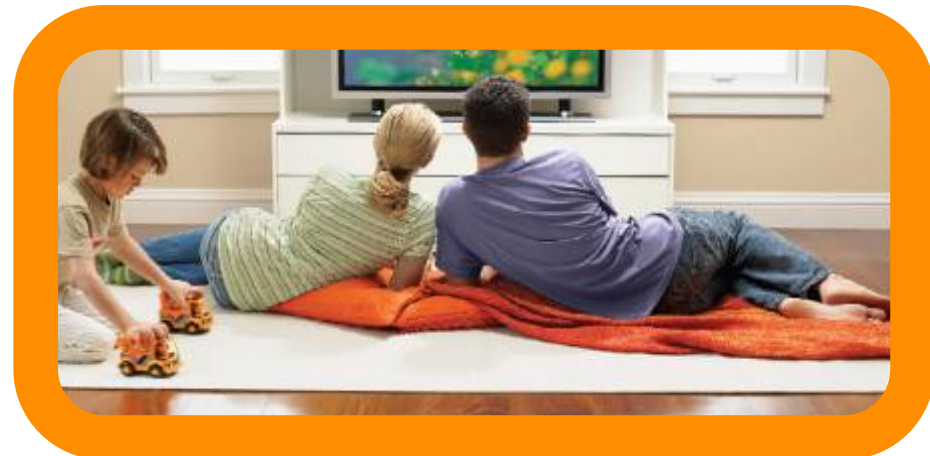

(3) Subscriber is on 2nd Floor (example)

VertiCasa Installation

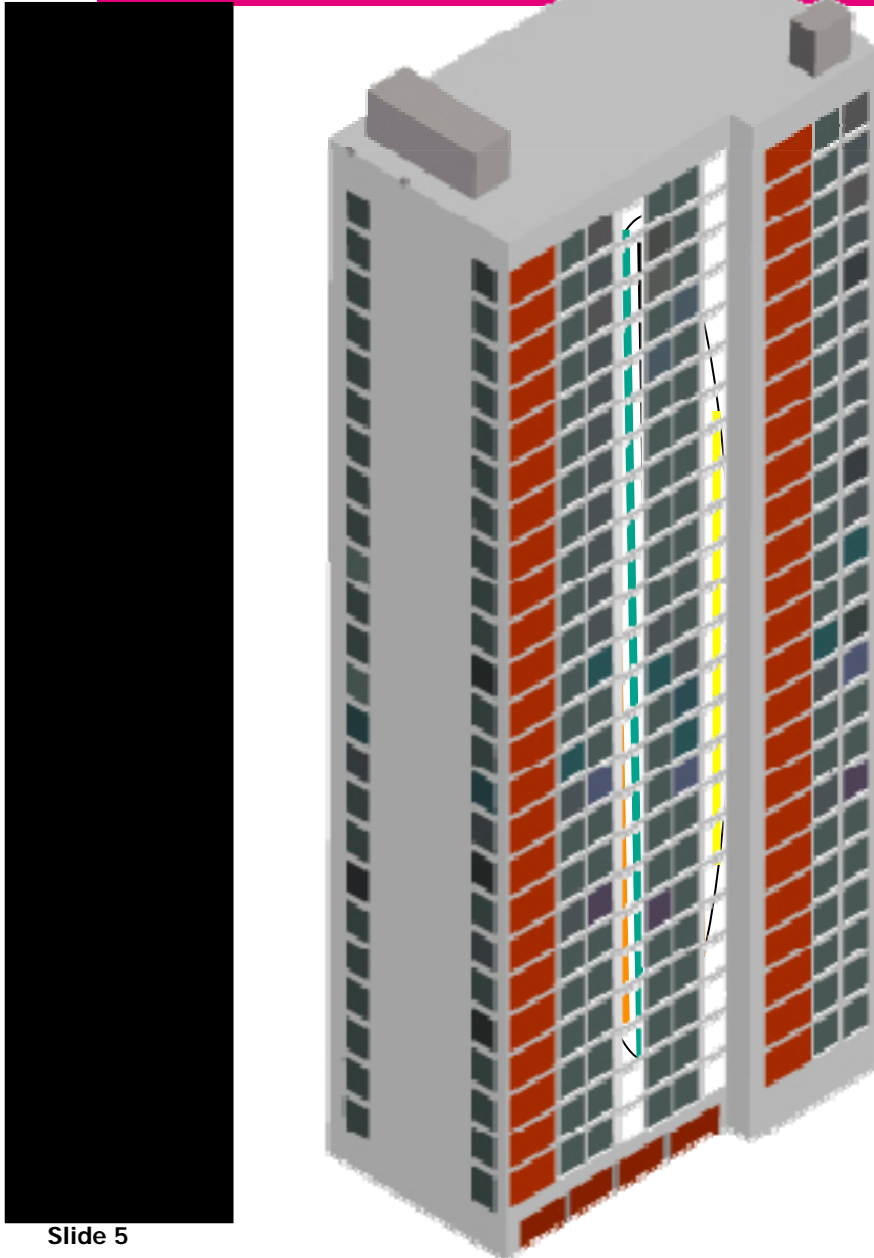

(5) Use Verticasa tool to cut breakout window in cable

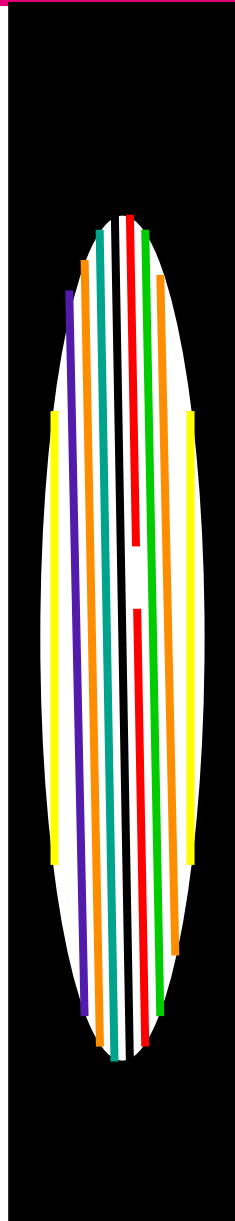

**(6) Select Extractable Fibre Unit (ESFU)
& cut this unit**

VertiCasa Installation

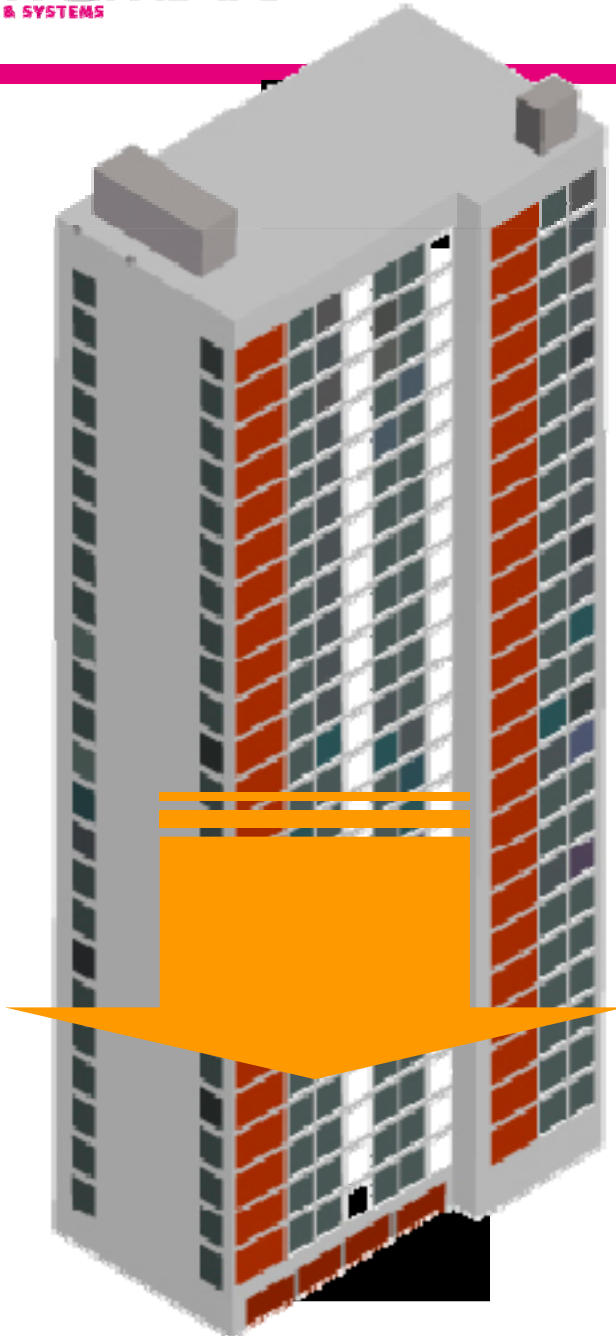

(7) Cover the breakout window with protection box

(8) Walk back to subscriber floor

VertiCasa Installation

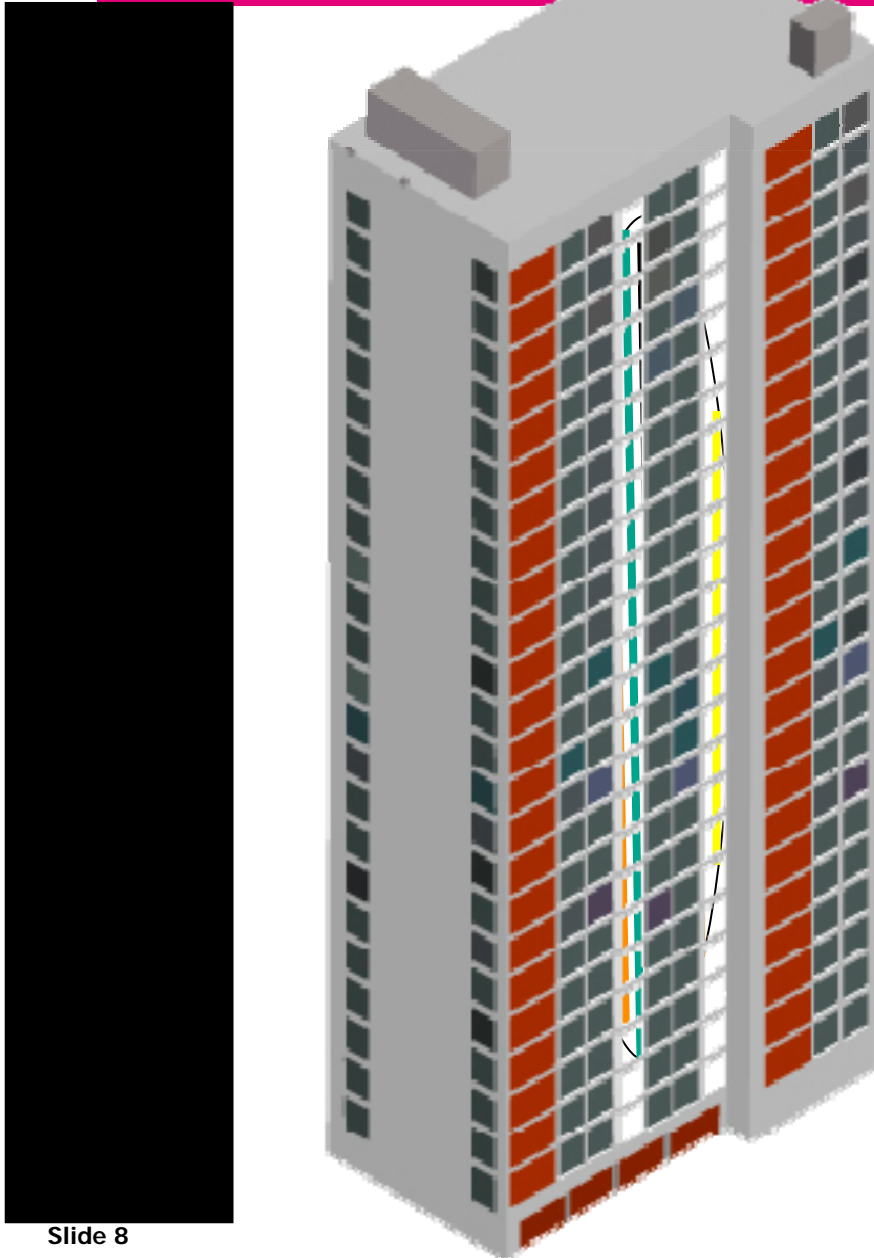

(9) Use Verticasa tool to cut breakout window in cable

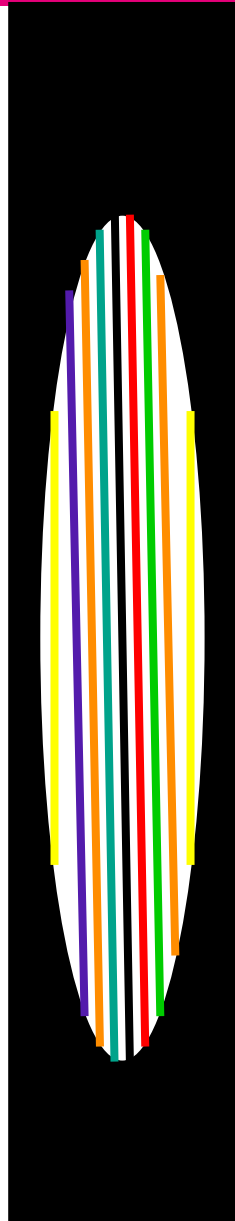

**(10) Select Extractable Fibre Unit (ESFU)
that was cut on higher floor**

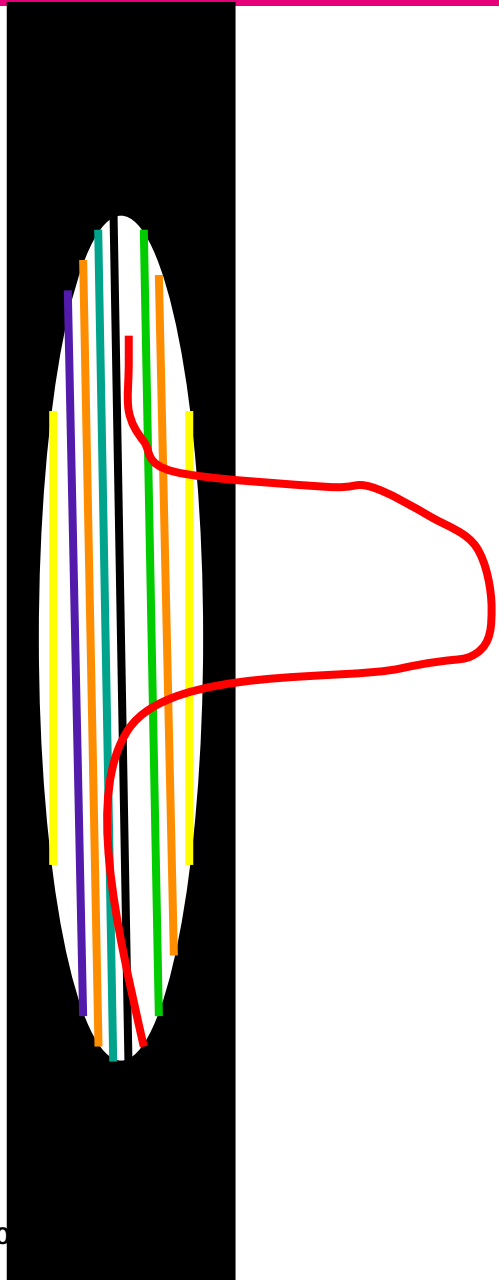

(11) Extract chosen ESFU from cable by up to 25m from cable

VertiCasa Installation

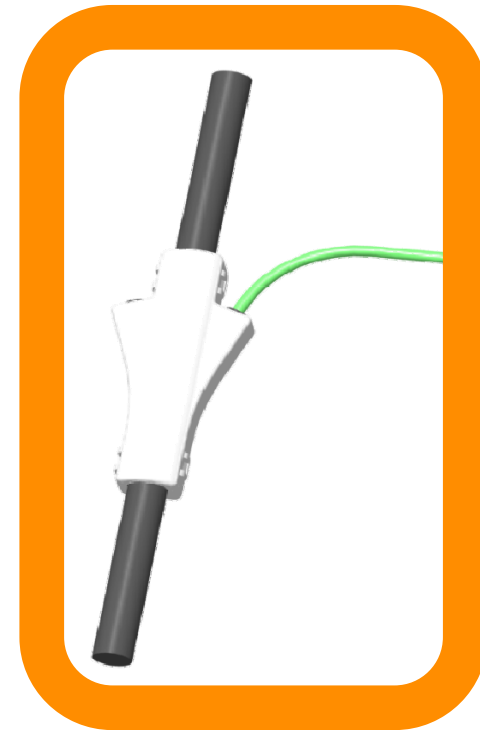
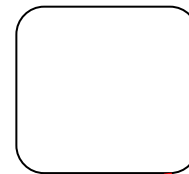

(12a) Use ESFU to connect subscriber with a variety of connectivity options

**Via a Y branch
(route ESFU to customer termination box via protective tube or trunking)**



VertiCasa Installation

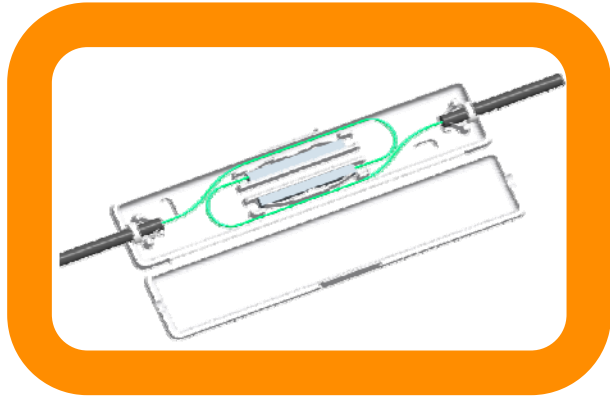
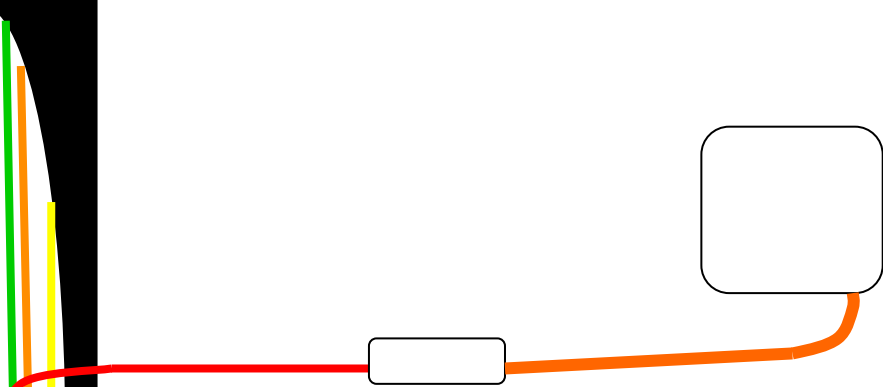
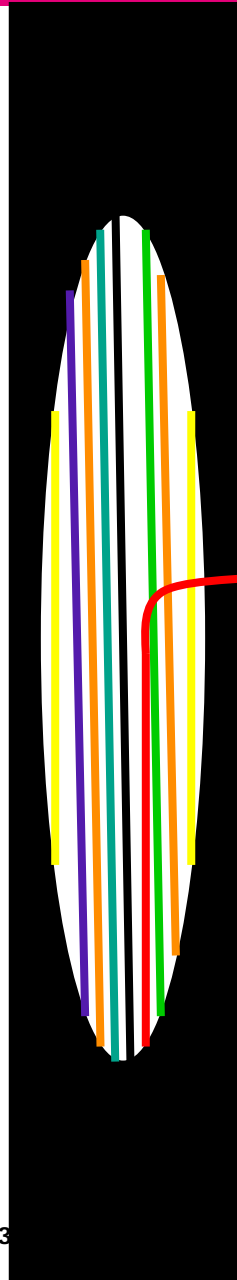

(12b) Use mechanical splice holder to connect to extension cable if greater length required to connect subscriber



VertiCasa Installation

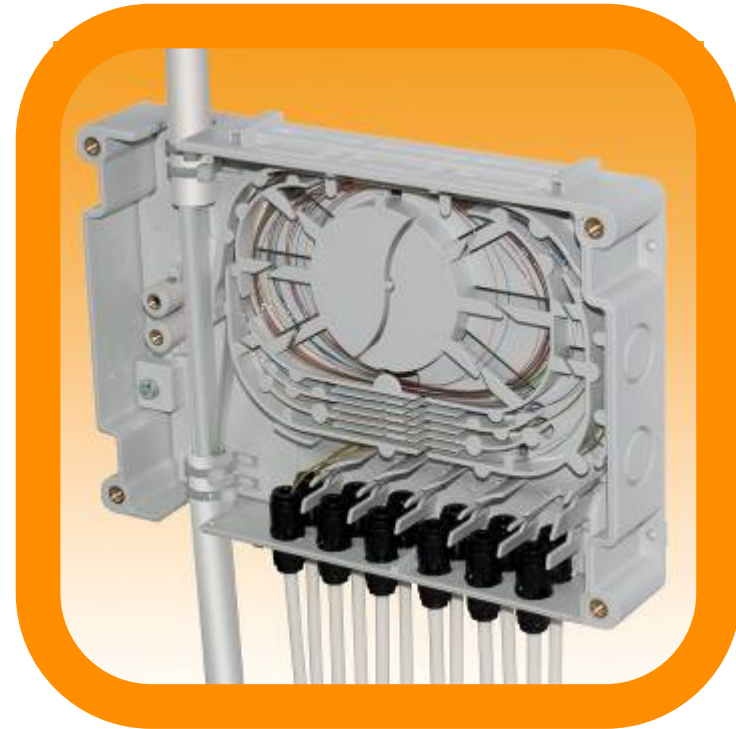
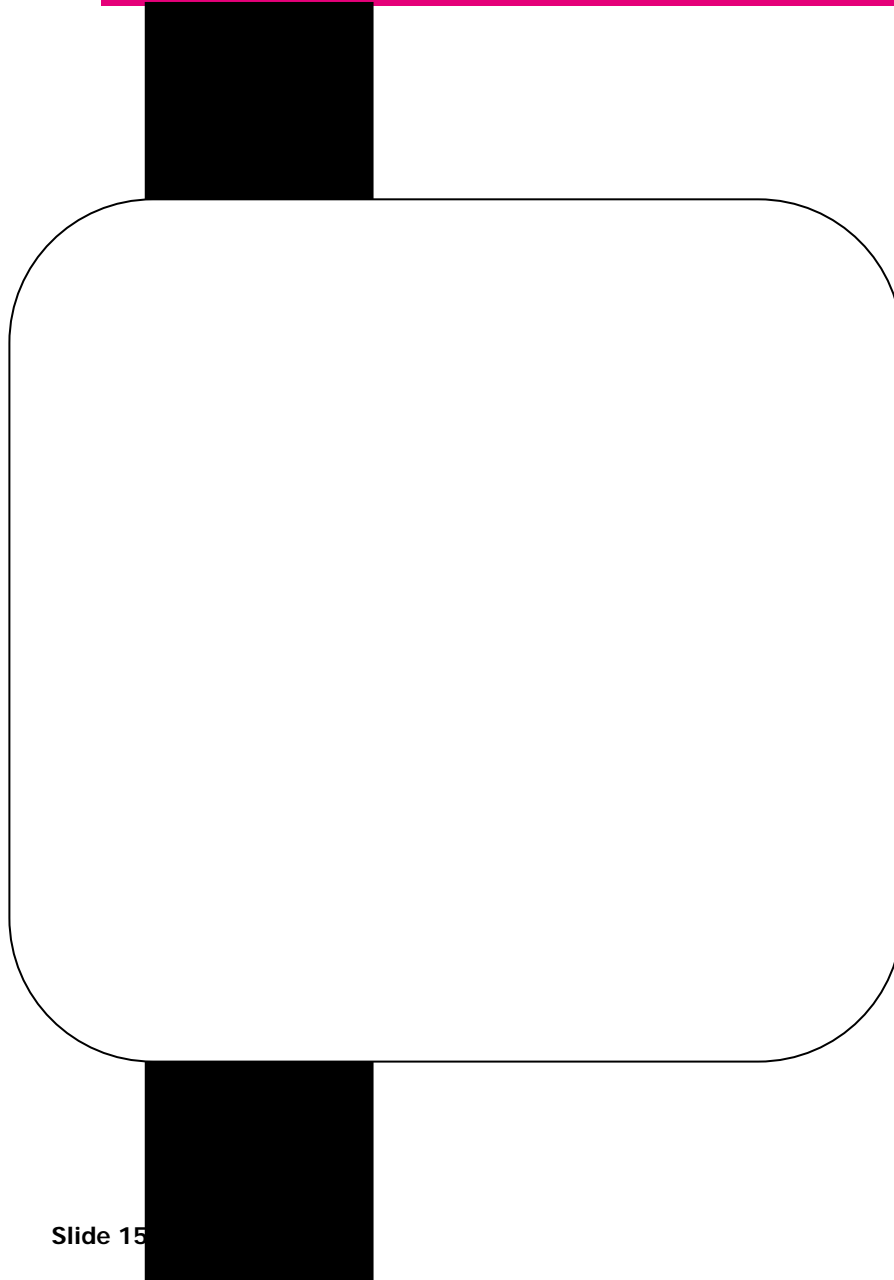

(12c) Use ESFU to connect subscriber with a variety of connectivity options

**Via a Riser Box
(splice to another cable drop)**

Property of Prysmian Telecom Cables & Systems

VertiCasa Installation



Termination Box Options



**4f Compact
Termination Box**

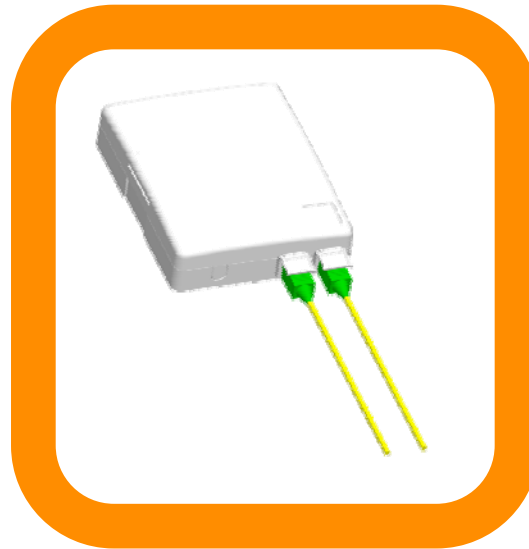

**2f Ultra Compact
Termination Box
(CasaLight)**



**Hybrid Ultra Compact
Termination Box
(Copper & CasaLight)**

VertiCasa – Features & Benefits

- **Patented cable system**
- **Variety of riser cable sizes (up to 96f)**
- **Multiple Single or Two fibre extractable units supplied in each cable**
 - Extractable units protected by LSOH tight buffered easy strip material
- **A range of supporting connectivity products for cable breakout, splicing and customer termination**
- **Latest Prysmian fibre technology supplied in VERTICASA cables**
- **Simple but innovative MDU cabling solution**
- **Reduced fusion splicing time, cost and power loss**

